

Combination: ELP 22/6/16 with ELP 22/6/16

ELP 22/6/16

Magnetic characteristics (per set)

$\Sigma/A = 0,41 \text{ mm}^{-1}$
 $l_e = 32,5 \text{ mm}$
 $A_e = 78,3 \text{ mm}^2$
 $A_{\min} = 77,9 \text{ mm}^2$
 $V_e = 2540 \text{ mm}^3$

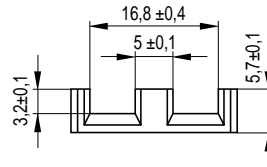

Approx. weight 13 g/set

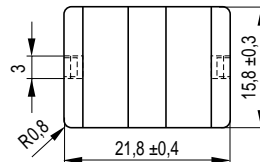

FEK0339-R

Ungapped

Material	A_L value nH	μ_e	$A_{L1\min}$ nH	P_V W/set	Ordering code (per piece)
N49	$3100 \pm 25 \%$	1010	1840	< 0,65 (50 mT, 500 kHz, 100 °C)	B66285-G-X149
N87	$4500 \pm 25 \%$	1470	2760	< 1,50 (200 mT, 100 kHz, 100 °C)	B66285-G-X187

Calculation factors (see page 423 for formulas)

ELP 22/6/16 + ELP 22/6/16:

Material	Relationship between air gap – A_L value		Calculation of saturation current			
	$K1$ (25 °C)	$K2$ (25 °C)	$K3$ (25 °C)	$K4$ (25 °C)	$K3$ (100 °C)	$K4$ (100 °C)
N87	126	- 0,814	232	- 0,796	200	- 0,873

Validity range: $K1, K2: 0,10 \text{ mm} < s < 1,50 \text{ mm}$
 $K3, K4: 100 \text{ nH} < A_L < 700 \text{ nH}$

Combination: ELP 22/6/16 with I 22/2,5/16

ELP 22/6/16

I 22/2,5/16

Magnetic characteristics (per set)

$\Sigma l/A = 0,33 \text{ mm}^{-1}$
 $l_e = 26,1 \text{ mm}$
 $A_e = 78,5 \text{ mm}^2$
 $A_{\min} = 77,9 \text{ mm}^2$
 $V_e = 2050 \text{ mm}^3$

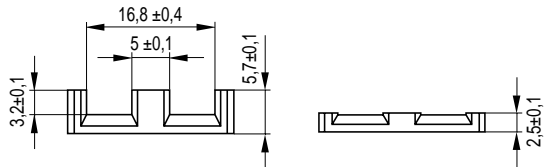

Approx. weight 10,5 g/set

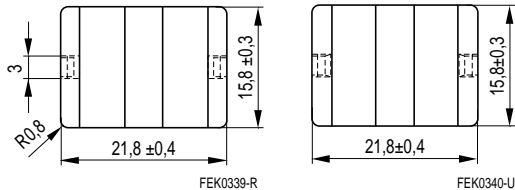

Ungapped

Material	A_L value nH	μ_e	$A_{L1\min}$ nH	P_V W/set	Ordering code (per piece)
N49	$3700 \pm 25 \%$	960	2290	< 0,50 (50 mT, 500 kHz, 100 °C)	B66285-G-X149 (ELP core) B66285-P-X149 (I core)
N87	$5200 \pm 25 \%$	1360	3430	< 1,25 (200 mT, 100 kHz, 100 °C)	B66285-G-X187 (ELP core) B66285-P-X187 (I core)

Calculation factors (see page 423 for formulas)

ELP 22/6/16 + I 22/2,5/16:

Material	Relationship between air gap – A_L value		Calculation of saturation current			
	$K1$ (25 °C)	$K2$ (25 °C)	$K3$ (25 °C)	$K4$ (25 °C)	$K3$ (100 °C)	$K4$ (100 °C)
N87	134	- 0,806	243	- 0,796	206	- 0,873

Validity range: $K1, K2: 0,10 \text{ mm} < s < 1,50 \text{ mm}$
 $K3, K4: 100 \text{ nH} < A_L < 700 \text{ nH}$

Clamp

Ordering code per piece, 2 pieces required

Ordering code: B65804-P2204

